

ASSEMBLY INSTRUCTIONS

HBC-21/24/30

INSTALLATION

STEP 1 - INSTALL HANDLE INTO FRAME.

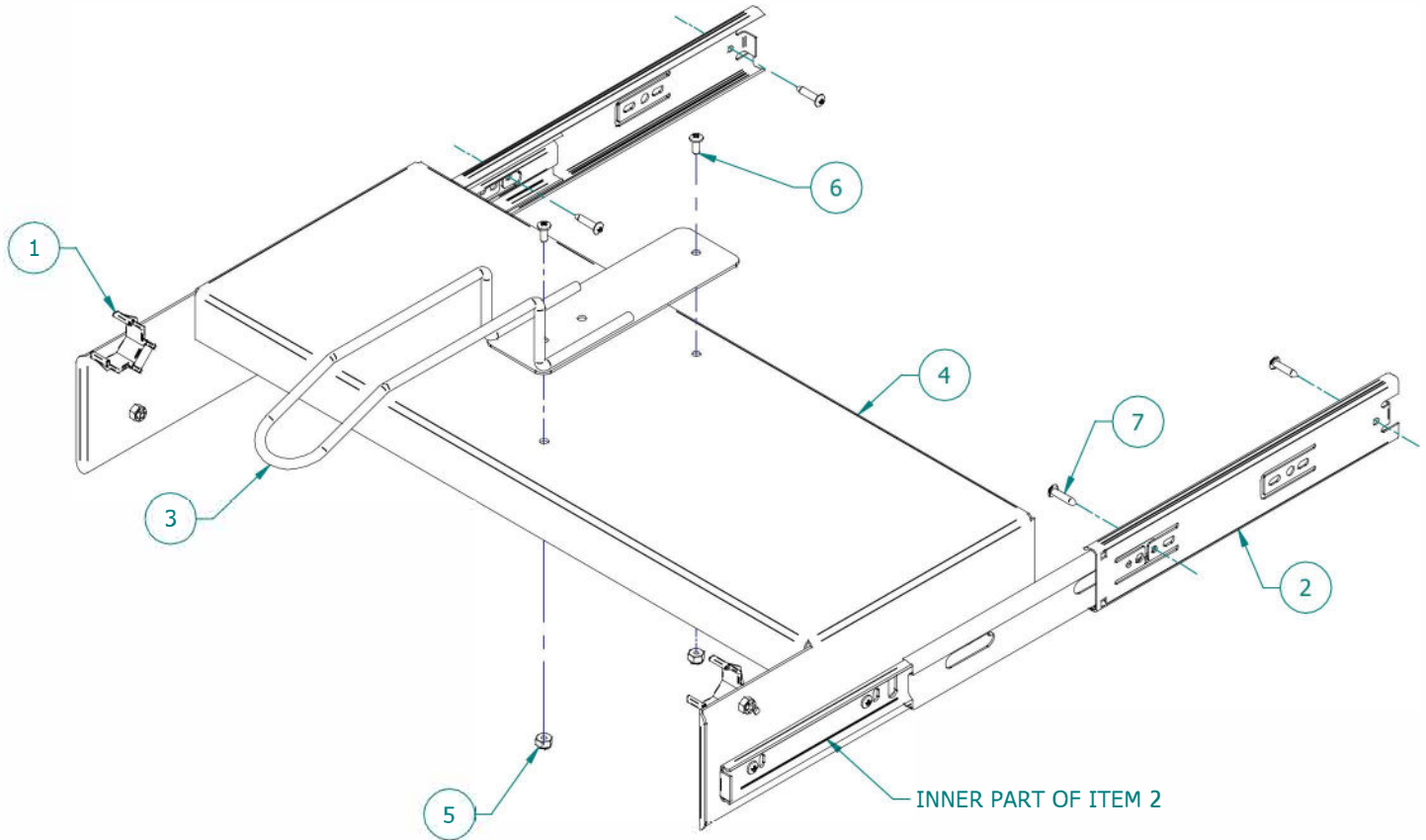

4	HARDWARE	SCREW, #8 X 3/4" WOOD PAN HD PHILLIPS	GRADE 2, ZINC	7
10	HARDWARE	SCREW, #8-32 X 3/8" PAN HD PHILLIPS	GRADE 2, ZINC	6
10	HARDWARE	NUT, #8-32UNC HEX NYLON-INSERT LOCKNUT	STEEL, ZINC	5
1	SEE TABLE 1	FLEX-COLLECT HANGERBAR CADDY	--	4
1	22241	HANDLE WELDMENT	--	3
2	21060	DRAWER SLIDE, 3-PC TELESCOPING SIDE-MOUNT SIQUAR 10" (254mm) EXTENSION 100LB PRECISION BALL-BEARING (SIQUAR#BS46B10) OR EQUIVALENT	--	2
2	21010	HANGERBAR CLIP	--	1
QTY. REQ'D	PART OR IDENTIFYING NO.	NOMENCLATURE OR DESCRIPTION	MATERIAL SPECIFICATION	ITEM NO.

ASSEMBLY INSTRUCTIONS

HBC-21/24/30

INSTALLATION

POSITION AND ATTACH SLIDES TO CABINETS AS RECOMMENDED BELOW.

NOTE: 1) IF USING HANGERS OF DIFFERENT SIZE AS SHOWN, ADJUST THESE DIMENSIONS ACCORDINGLY.

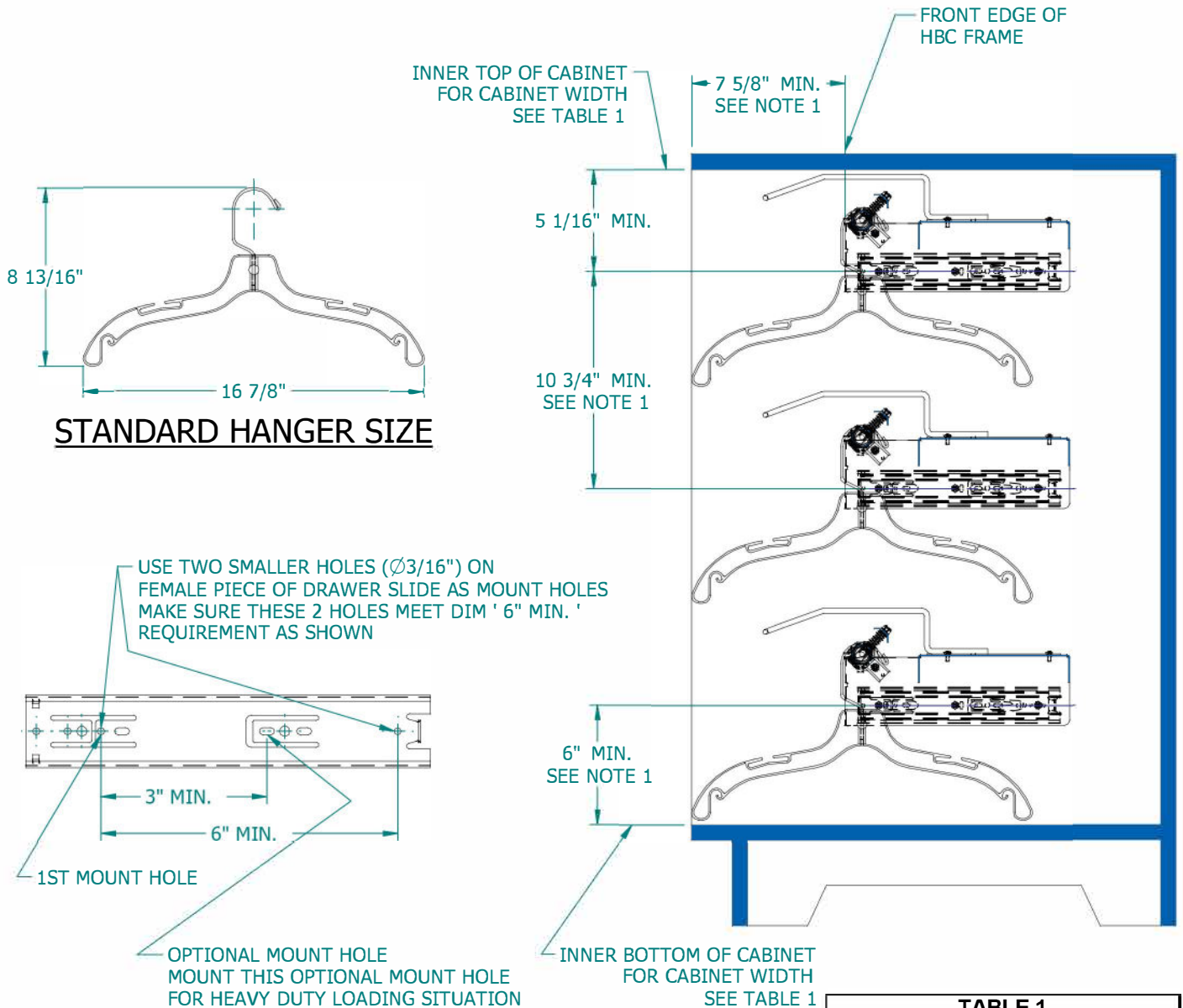

TABLE 1

CABINET WIDTH

ITEM 4	INCHES	mm
HBC-21	21 1/2	545
HBC-24	25 1/8	638
HBC-30	30 1/2	774